

CAD DRAWING DO NOT MODIFY

REMOVE ALL SHARP CORNERS/EDGES

DO NOT SCALE DRAWING

UNCONTROLLED COPY
NOT FOR PRODUCTION
UNLESS OVERSTAMPED
"CONTROLLED"
IN RED INK

| BY | DATE | ALTERATIONS | ISSUE |
|-----|------------|---------------------------|-------|
| CVA | 24/11/2020 | INITIAL RELEASE CE19-227A | 1 |
| - | - | - | - |
| - | - | - | - |
| - | - | - | - |

| ITEM NO. | Number | DESCRIPTION | QTY. | Units | CUTSIZE | TOL +/- | IMAGE | LOOSE |
|----------|-------------|--|------|-------|--------------------------|----------------|-------|--------------|
| 1 | 83/66981/01 | Fabricated Backstrap | 1 | EACH | See Sheet 4 | | | |
| 2 | 83/66981/02 | Roller Tube Assembly | 1 | EACH | See Sheet 3 | | | |
| 3 | 83/66981/03 | Roller Tube -Section No 29/64536 | 1 | EACH | 1505.3 | +0.00 -0.75 | | |
| 4 | 83/66981/04 | Guide Tube -Section No 29/50799 | 1 | EACH | 1519 | +0.00 -0.75 | | |
| 5 | 83/66981/05 | WIDNEY Spec 12.4 Mesh Widney Spec 12.1 - Velbex | 1 | EACH | 1500 x 900 1500 x 250 | +/-1.0 | | |
| 6 | 83/66981/06 | Guide Bar - Dia6.35 Alumniium Rod | 2 | EACH | 358.0 | | | |
| 7 | 83/66981/07 | Lower Guide Tube Assembly | 1 | EACH | See Sheet 3 | | | |
| 8 | 83/66981/08 | GUIDE BAR ASSY | 2 | EACH | See Sheet 3 | | | Supply Loose |
| 9 | 83/64537 | 24V Electric Motor Assembly | 1 | EACH | | | | |
| 10 | 83/64538 | End Moulding Assembly | 1 | EACH | | | | |
| 11 | 502/001/001 | 3.5 x 8 Plas Tech Screw | 2 | EACH | | | | |
| 12 | 83/57450/01 | Upper Guide Bar Retainer | 2 | EACH | | | | |
| 13 | 21/54515 | RUBBER WASHER | 2 | EACH | | | | |
| 14 | 83/49803/1 | GUIDE | 2 | EACH | | | | |
| 15 | 83/49819/1 | Kit Bag 15 | 1 | EACH | | | | Supply Loose |
| 16 | 705/000/011 | Tesa Tape | 2 | EACH | 1505.3 | +/-1.0 | | |
| 17 | 29/47187 | Sealing Rubber | 1 | EACH | 2805 | +/-1.0 | | |

Notes -

1. Electric Motor fitted to L.H Side
2. Motor Travel to be set before blind assembly is dispatched as follows -
 - Hold up or down and press setting key on motor for 6 seconds
 - Motor will beep "Di, Di, Di"
 - Drive the motor/blind to the required up position and stop
 - Press up once briefly
 - Motor locks into up position (Can feel motor lock)
 - Drive motor/blind to required lower position - Stop at required position
 - Press down once briefly
 - Motor locks into down position (Can feel motor lock)
 - Press "up" briefly - Motor will beep "Di"
 - Postions are now set

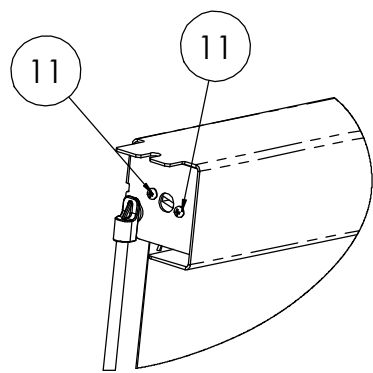
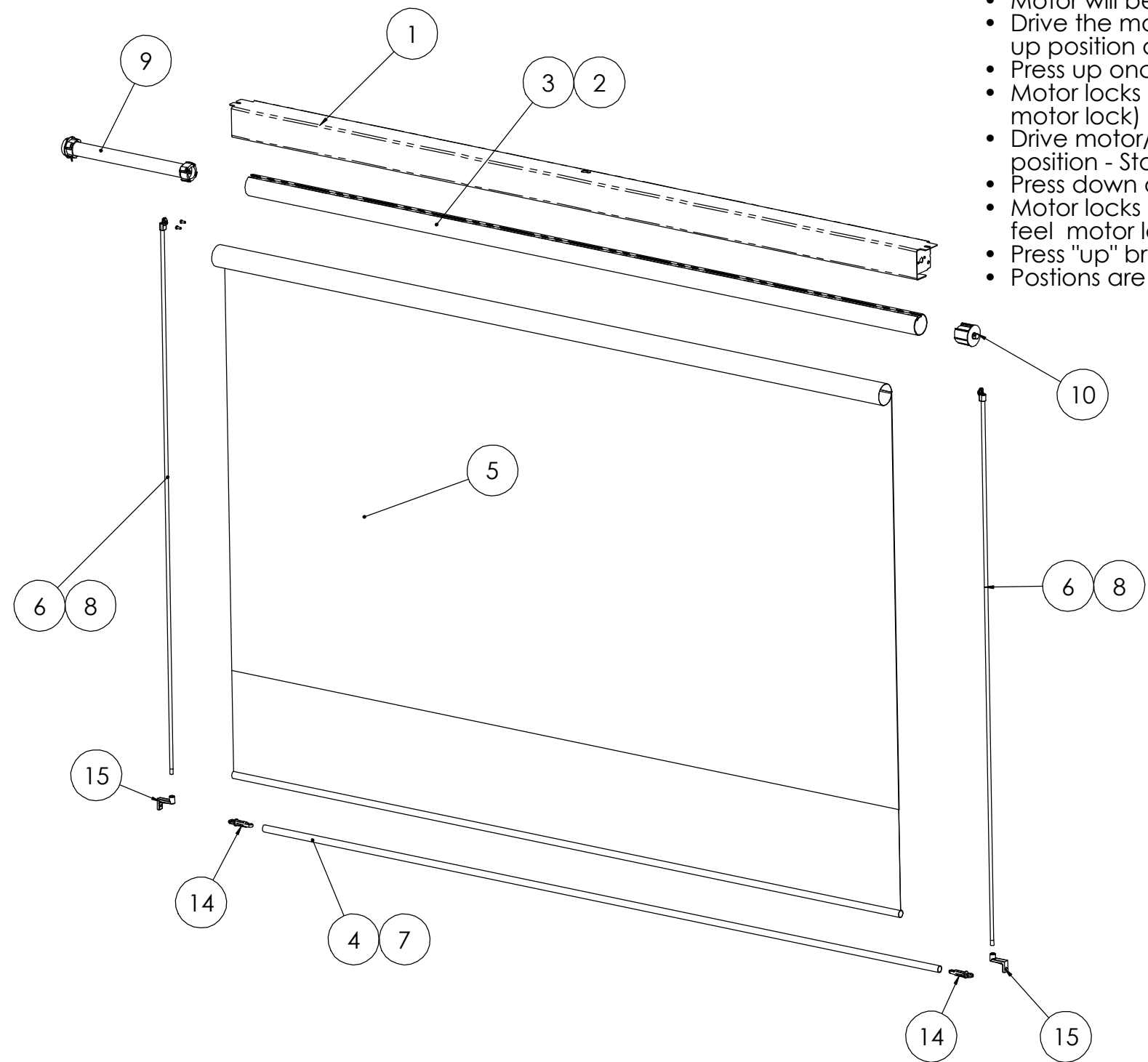

SEE NOTES
SCALE 1:2

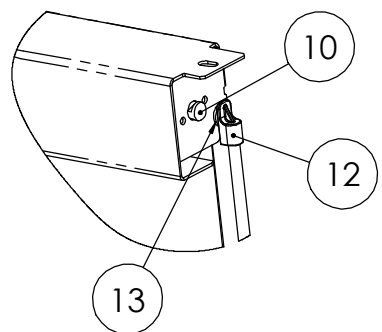

SEE NOTES
SCALE 1:2

| | |
|---|-----------------------|
| DESIGNER | CVA 24/11/2020 |
| TOLERANCES UNLESS OTHERWISE SPECIFIED | |
| X X.X X.XX HOLE CRS ANGULAR | |
| MATERIAL | SEE COMPONENT DETAILS |
| FINISH | SEE COMPONENT DETAILS |
| WEIGHT | CE No. CE19-277a |
| Widney | |
| TITLE | ELECTRIC BLIND |

| | | |
|---------|----------|-----------------------------|
| PART No | 83/66981 | SHT 1 OF 5 ISSUE 1 |
|---------|----------|-----------------------------|

CAD DRAWING DO NOT MODIFY

REMOVE ALL SHARP CORNERS/EDGES

DO NOT SCALE DRAWING

UNCONTROLLED COPY
NOT FOR PRODUCTION
UNLESS OVERSTAMPED
"CONTROLLED"
IN RED INK

| BY | DATE | ALTERATIONS | ISSUE |
|-----|------------|---------------------------|-------|
| CVA | 24/11/2020 | INITIAL RELEASE CE19-227A | 1 |
| - | - | - | - |
| - | - | - | - |

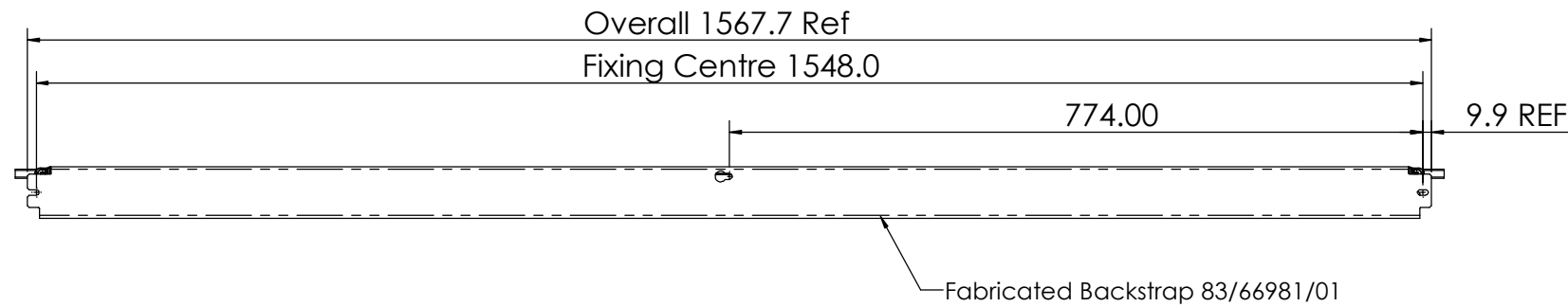

83/66981/03 Roller Tube - 1505.3^{0.00}_{-0.75}
 Section No 29/64536
 83/66981/02 Roller Tube Assembly

83/66981/02 Roller Tube Assembly retaining in place by 502/001/001 Plus Tech Screws

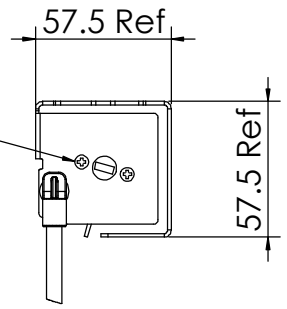

DETAIL L
SCALE 10 : 16

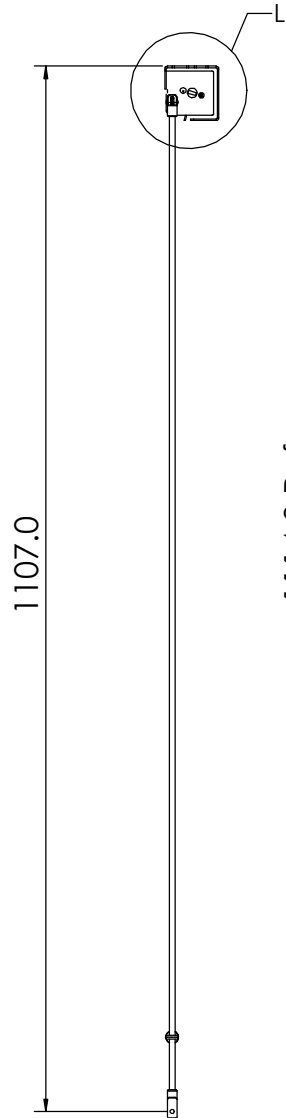

1114.0 Ref

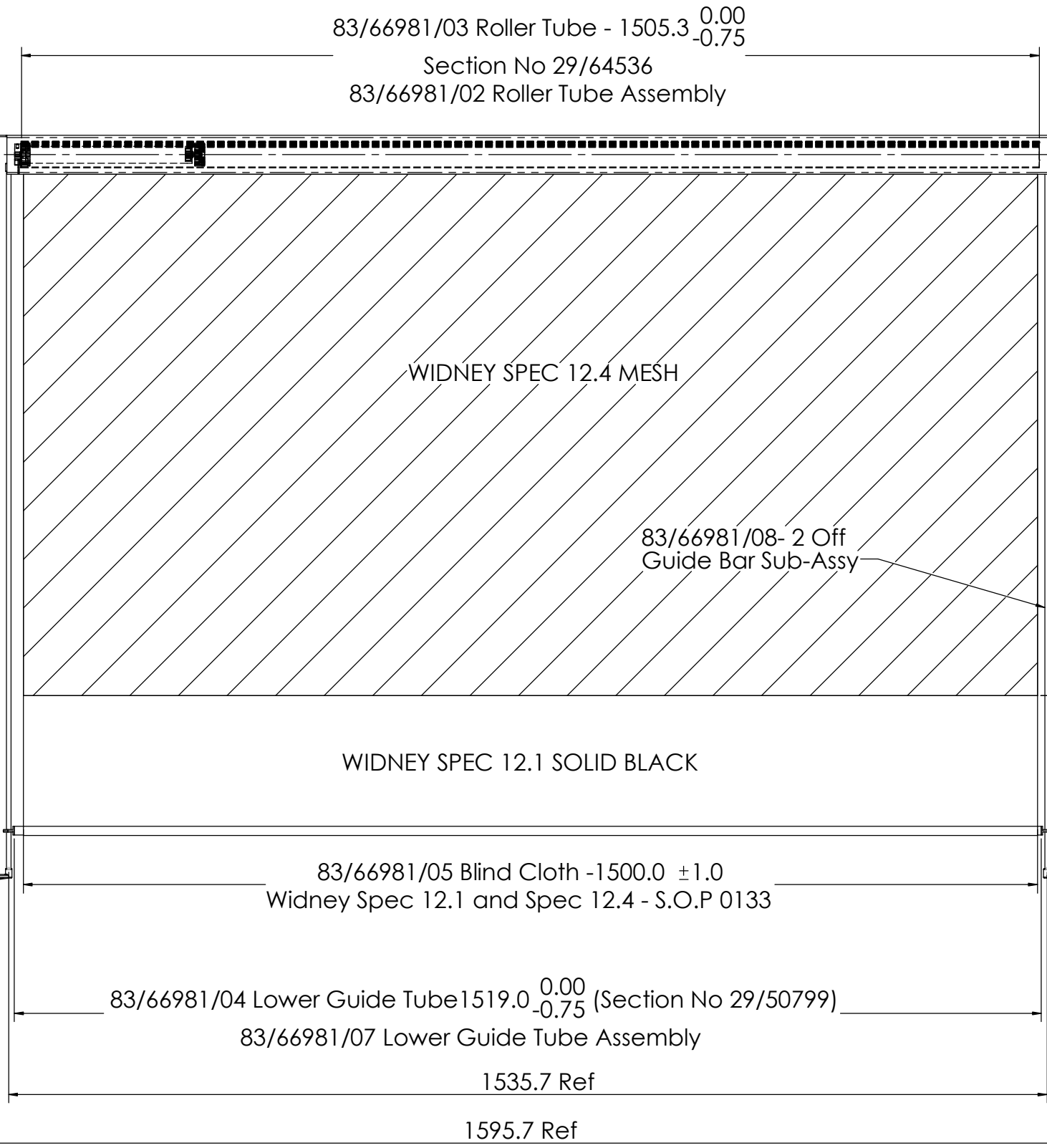

800.0
WIDNEY SPEC 12.4 MESH

200.0
WIDNEY SPEC 12.1 SOLID BLACK

Maximum Drop 1000.0 Ref

WIDNEY SPEC 12.1 SOLID BLACK

83/66981/05 Blind Cloth -1500.0 ±1.0
Widney Spec 12.1 and Spec 12.4 - S.O.P 0133

83/66981/04 Lower Guide Tube 1519.0^{0.00}_{-0.75} (Section No 29/50799)

83/66981/07 Lower Guide Tube Assembly

1535.7 Ref

1595.7 Ref

| | |
|---------------------------------------|-----------------------|
| DESIGNER | CVA 24/11/2020 |
| TOLERANCES UNLESS OTHERWISE SPECIFIED | |
| X | ± 0.5 |
| X.X | ± 0.25 |
| X.XX | ± 0.15 |
| HOLE CRS | ± 0.15 |
| ANGULAR | ± 0.5° |
| MATERIAL | SEE COMPONENT DETAILS |
| FINISH | SEE COMPONENT DETAILS |
| WEIGHT | CE No. CE19-277a |
| Widney | |
| TITLE | ELECTRIC BLIND |
| PART No | 83/66981 |
| | SHT 2 OF 5 ISSUE 1 |